

Installation Manual

A reference guide for installing AMCASE® product.

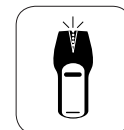
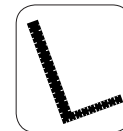
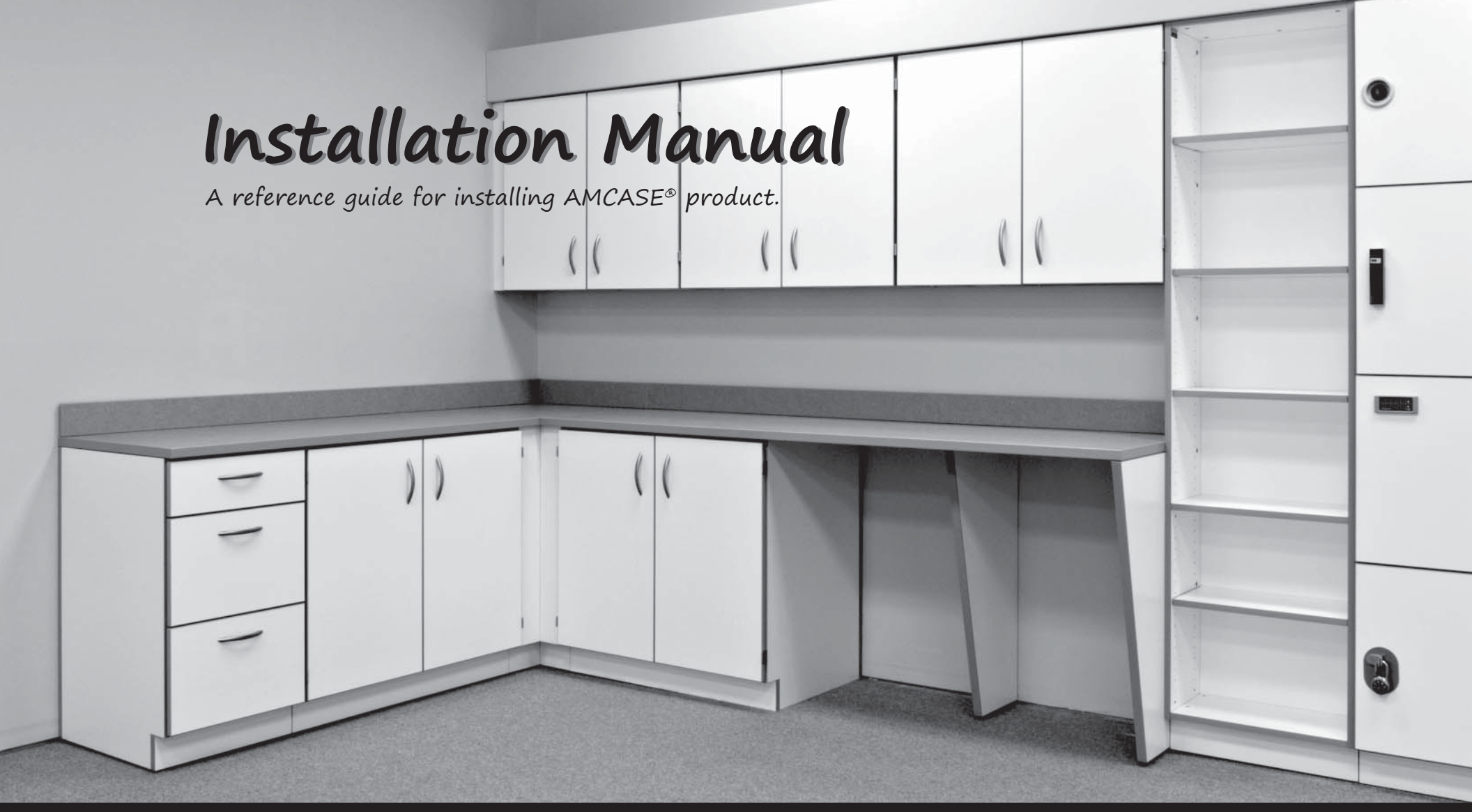

Corporate Office & Manufacturing Facility

2880 Ridgewood Park Drive

Winston-Salem, NC 27107

p: (888) 396-9060

f: (336) 499-5992

e: sales@amcase.com

www.amcase.com

Copyright © 2011 – 2015. All rights reserved.
printed in the u.s.a. 11-2011 v1.6

Table of Contents

Overhead Cabinets.....	4
Marking cabinet positions.....	5
Installing overhead mounting rails.....	5
Removing doors	6
Mounting and leveling cabinets	6
Connecting cabinets together.....	7
Installing fillers	8
Reattaching doors.....	8
Leveling doors.....	(Fit & Finish)
Installing pulls.....	(Fit & Finish)
Notes.....	9

Base Cabinets.....	10
Marking cabinet positions.....	11
Removing doors/drawers.....	11
Finding the highest point.....	11
Adjusting levelers	12
Leveling cabinet	12
Installing corner fillers	12-13
Placing and leveling all cabinets.....	14
Connecting cabinets together.....	14
Attaching doors/drawers.....	(Fit & Finish)
Leveling doors/drawers	(Fit & Finish)
Installing pulls.....	(Fit & Finish)
Notes.....	15

Work Surfaces.....	16
Installing support panels/brackets	17
Installing work surfaces.....	17-18
Attaching work surfaces to cabinets.....	18
Additional support panels	18
Backsplashes and sidesplashes	18
Notes.....	19

Fit & Finish.....	20
Installing shelves	20
Attaching doors/drawers.....	20
Leveling doors.....	20
Leveling drawers	21
Installing pulls.....	21
Notes.....	22-23



Installing AMCASE® Overhead Cabinets

Welcome. This page is a guide for assisting you in installing the AMCASE® product efficiently and accurately.

Please review the list before getting started.

Quick Steps Overview:

1. Mark cabinet positions
2. Mark mounting rail, studs, etc.
3. Install mounting rail with toggles
4. Mount and level overhead cabinets
5. Fasten cabinets together
6. Install fillers
7. Reattach doors
8. Level doors and flip pulls

Tools Needed:

- 4ft Level
- 6ft Ladder
- Allen Wrenches (4 mm)
- Belt Sander
- Caulking Gun & Caulk
- C-clamps (variety)
- Circular Saw
- Cordless Drill
- Drill Bits - Metal/Wood
- Framing Square
- Hand Screwdrivers
- Industrial Grade Extension Cords
(Surge protector may be needed)
- Jig Saw
- Laser with Tripod (recommended)
- Magnetic Torpedo Level
- Miter Saw
- Multi-Surface Cleaner

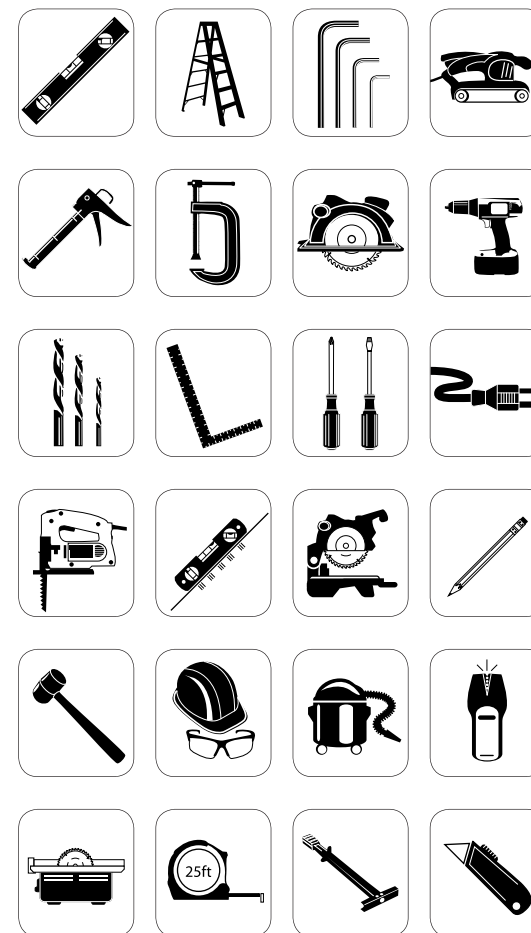

- Pencil and Markers
- Rubber Mallet
- Safety Glasses, Boots, Hat, etc.
- Shop Vac
- Stud Finder
- Table Saw (Lam. Cutting Blade)
- Tape Measure
- Toggle Bolts with Screws 3/16-24
Toggler brand zip toggles preferred
with screw lengths specific for job
(not provided by AMCASE®).
- Utility Knife

Installing AMCASE® Overhead Cabinets

Tools Needed:

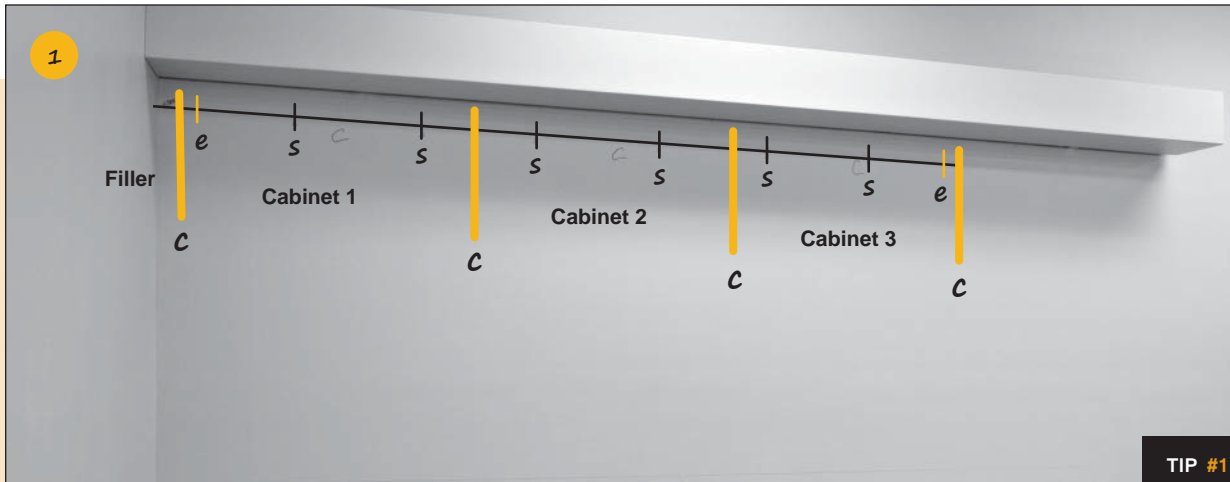
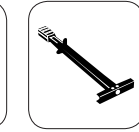
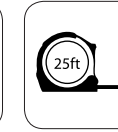
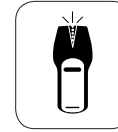
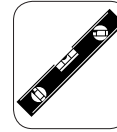

TIP #1

Have drawings ready for reference. Mark the top location of each wall cabinet. Measure down 3 5/8" and draw horizontal line. Mark left and right side panel locations (c) stud locations (s), and ends of mounting rail (e). Be sure to include all fillers in calculation of dimensions.

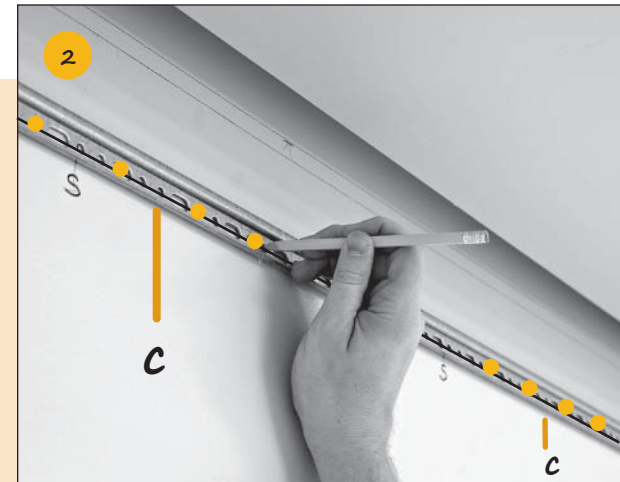

TIP #1
The mounting rail should be 3" shorter than the total run of overhead cabinets.

TIP #2
Be mindful of services (plumbing, electrical, gas) in the wall before drilling.

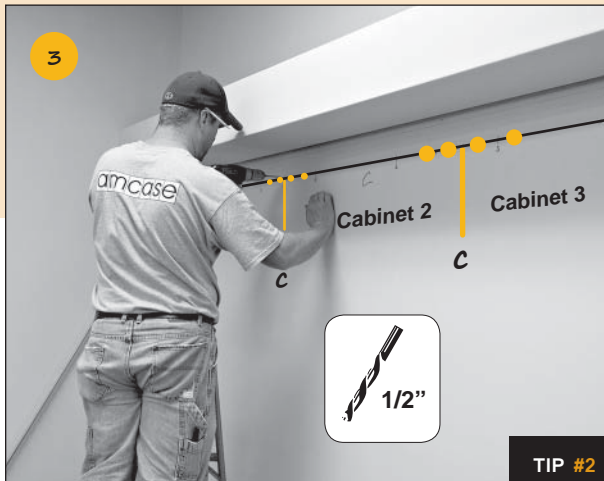

TIP #2

Remove the mounting rail and drill marked holes with a 1/2" drill bit. Be mindful of services (plumbing, electrical, etc.) in the wall before drilling.

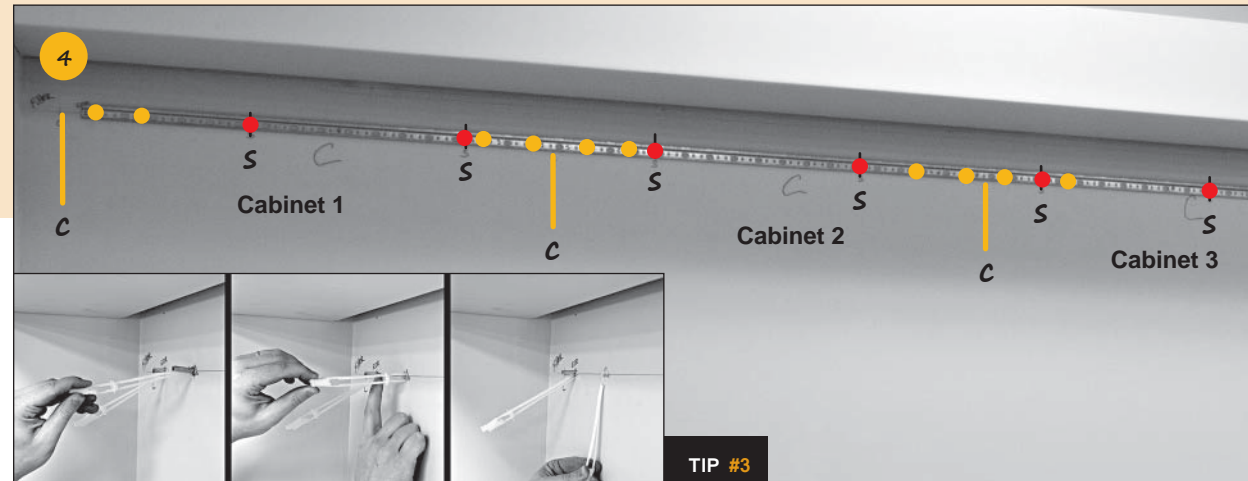

TIP #3

Insert togglers into drilled holes. Mount the rail using the screws for the togglers. Secure the mounting rail to studs where possible with the proper screws.

● togglers ● stud fastener

TIP #3
In addition to toggle bolts and screws, It is required by AM-CASE® to anchor the mounting rail to any available studs with the proper fastener.

Installing AMCASE® Overhead Cabinets

Tools Needed:



TIP #4

Turn the discs on the mounting brackets to their fully extended position before mounting the overhead cabinets. This will make it easier to hang the cabinets.

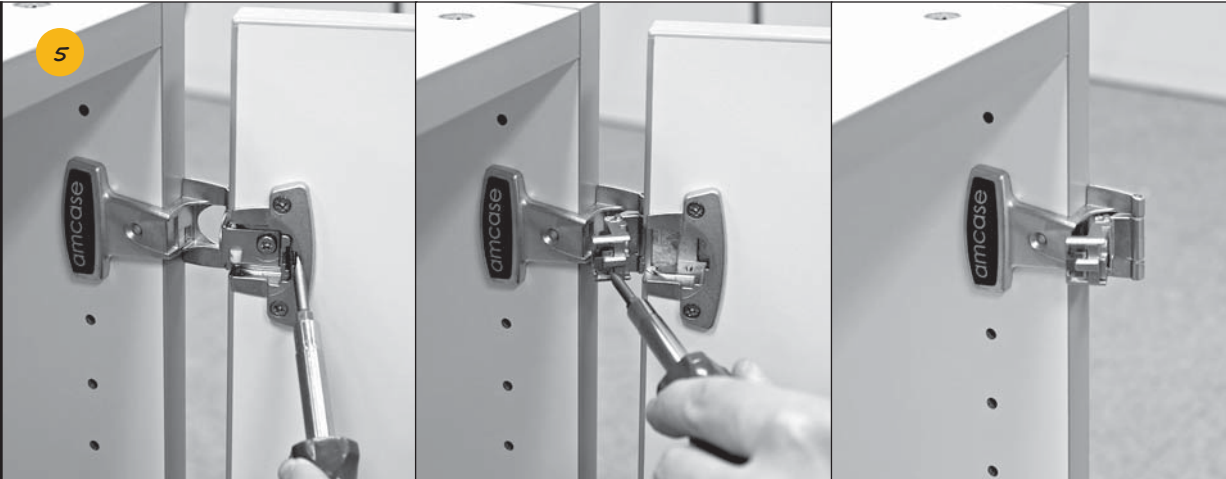

Remove all the doors from the overhead cabinets before installing them. Using a Flathead screwdriver, release the hinge from the door mount. A slight turn may help to release it.



Hang the first cabinet on the mounting rail. The circular discs on the brackets must be seated over the lip of the rail.



Once the cabinet is positioned according to plans, locate the two access holes to begin leveling the cabinet.

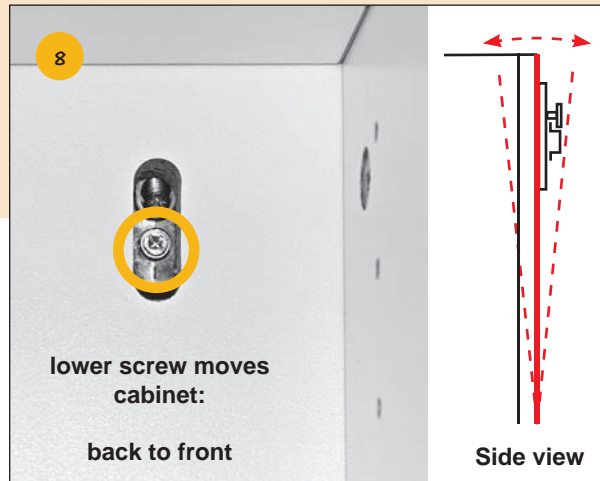

The lower screw adjusts the plumb of the cabinet. Turn it clockwise to secure the cabinet closer to the wall.

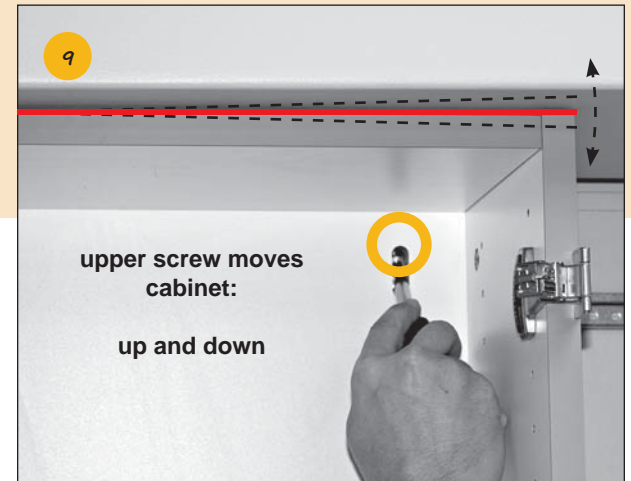

The upper screw adjusts the cabinet vertically and is used to level the cabinet horizontally.

Installing AMCASE® Overhead Cabinets

Tools Needed:

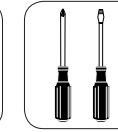
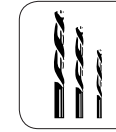
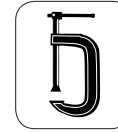
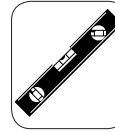

Continue to place and level remaining overhead cabinets according to plans.



Locate your hardware box(es). Here you will find many of the fasteners, caps, and brackets you need to complete your installation.



TIP #5
Select system holes in the top and bottom that will not be used for shelves.

TIP #6
Use a backer such as a piece of wood when drilling through side panels to avoid chipping laminate surface.



Using a 1/4" drill bit, ream one system hole on the top and one on the bottom of the side panels for connecting bolts.



Use the provided connecting bolts in the hardware box to secure the top and bottom of the side panels together.



Once all overhead cabinets are fastened together with connecting bolts, we are ready to install the filler strip.

Installing AMCASE® Overhead Cabinets

Tools Needed:

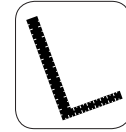

TIP #7

Use a belt sander or jig saw for fillers that fit against uneven walls.

TIP #8

Use a counter-sink drill bit for finishing the holes. This will prevent the screws from interfering with possible shelf locations.

16



Fillers are best installed after you have all of your overhead cabinets mounted. Especially in wall to wall situations.

17



TIP #7

Scribe cut the filler(s) to size.

18



TIP #8

Select two (2) or three (3) spots to drill pilot holes for securing filler panel. Filler should be flush with the front of cabinet body & bottom of cabinet.

19



Once the filler(s) are installed, next we are ready to reattach the door fronts.

20



Reattach the door fronts to each cabinet by pressing the hinge into the door mount. You should hear a click when it seats properly.

21



Once all the doors are attached, clean up with a vacuum to prepare for base cabinets. Leveling doors and installing pulls is discussed in the "Fit and Finish" section.

Notes

On Installing Overhead Cabinets

[illegible]

REVIEW

3 5/8"

Distance
from top
of over-
head to
center of
mounting
rail.

1/2"

Drill bit
size for
toggles.

3”

How much shorter mounting rail should be than total run of cabinets.

1/4"

Drill bit
size for
reaming
holes for
connecting
bolts.



Installing AMCASE® Base Cabinets

Welcome. This page is a guide to installing AMCASE® base cabinets efficiently and accurately. Please review the list before getting started.



Quick Steps Overview:

1. Mark cabinet positions
2. Remove doors/drawers
3. Place cabinet on highest point
4. Level cabinet
5. Place and level all cabinets
6. Install corner fillers
7. Gang cabinets together
8. Attach doors/drawers
9. Level doors and drawers
10. Install pulls

Tools Needed:

- 4ft Level
- Allen Wrenches (4 mm)
- Belt Sander
- Broom and Dust Pan
- Caulking Gun & Caulk
- C-clamps (variety)
- Circular Saw
- Cordless Drill
- Drill Bits – Metal/Wood
- Framing Square
- Hand Screwdrivers
- Industrial Grade Extension Cords
(Surge protector may be needed)
- Jig Saw
- Miter Saw
- Multi-Surface Cleaner
- Pencil and Markers
- Rubber Mallet

Pictured here are two base cabinets in process of being fastened together with connecting bolts.

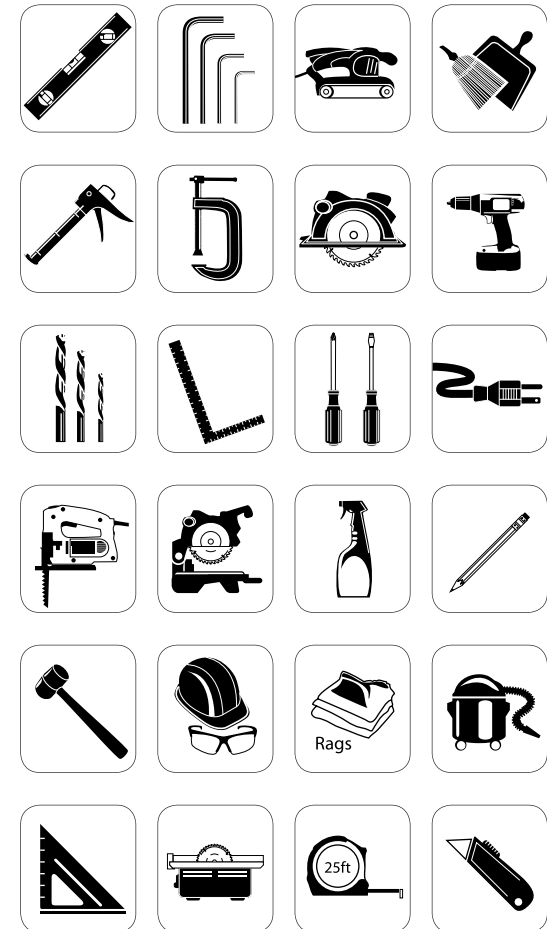

- Safety Glasses, Boots, Hat, etc.
- Shop Rags
- Shop Vac
- Speed Square
- Table Saw (Lam. Cutting Blade)
- Tape Measure
- Utility Knife

Installing AMCASE® Base Cabinets

Tools Needed:

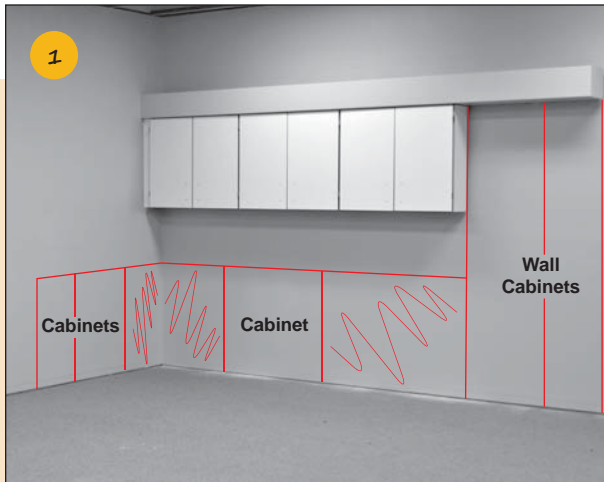
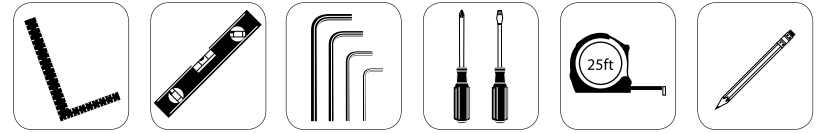

Mark the placement of base cabinets according to plans.

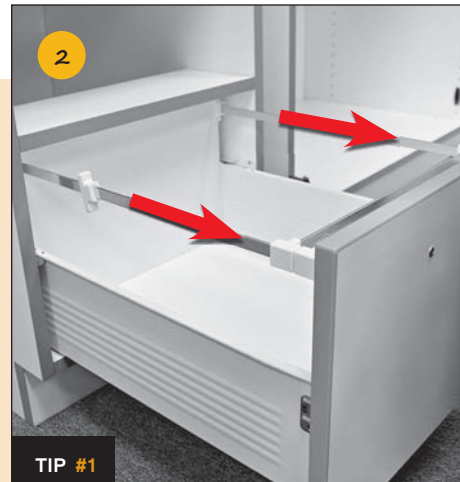

TIP #1

Remove the doors/drawers on all base cabinets. For file drawers, remove the hanging file rails by sliding the plastic caps forward, then lift up to remove the rail from rail stay. Next, fully extend the drawer and lift the drawer front up and over to clear the drawer guide wheels. For details on removing doors, see section on installing overhead cabinets.

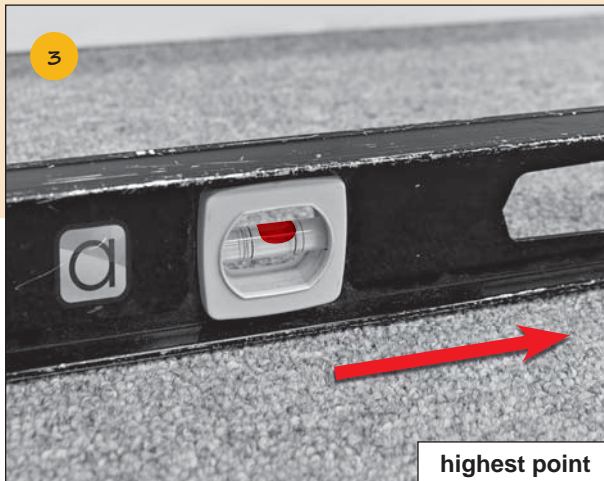

Use the level (or laser level) to find the highest point of the floor. This is where you will place your first cabinet.



Adjust levelers so they are not extended. This first cabinet on the high point needs to sit as close to the ground as possible.



Next, place your cabinet according to plans, beginning with the cabinet that sits on the highest point first.

TIP #1
On larger projects, it is a good practice to label the drawers and their positions relative to each cabinet before removing them.

Doors can be easily removed using a Flathead screwdriver. See installing overhead cabinets for more details.

Installing AMCASE® Base Cabinets

Tools Needed:

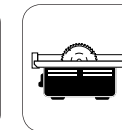
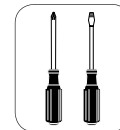
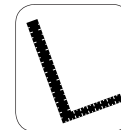
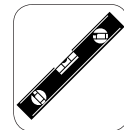

TIP #2

Additional cabinets will be placed towards the lower points of the floor since the first cabinet is on the highest point. Therefore, raise them up to make them level with other cabinets.

TIP #3

Place an angle bracket against the edge of the panel to keep brackets flush when fastening down.

6



Level this cabinet by accessing levelers through the holes in the cabinet floor. Use a 4 mm Allen wrench to adjust the height of each leveler as needed.

7



Continue to adjust each of the levelers until the cabinet is level side to side, and front to back.

8

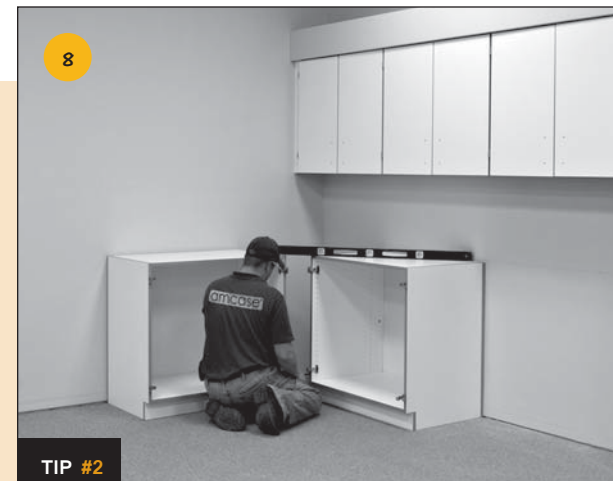

TIP #2

Place the next cabinet according to plans and raise it so that its top is level with the first cabinet.

9

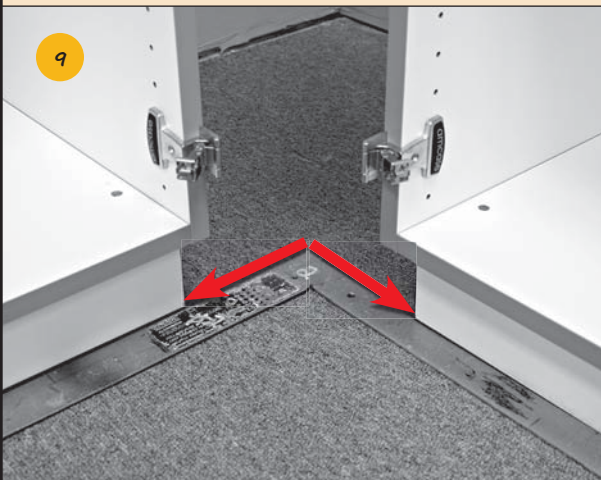

Base cabinet corner fillers consist of a lower toekick and an upper filler assembly. First measure and cut the toekick assembly to width.

10



Locate your hardware box(es). It contains many of the fasteners, caps, and brackets you need to complete your installation.

11



TIP #3

Use the supplied smaller angle brackets and attach two (2) per side on the cut edges of the toekick panel assembly.

Installing AMCASE® Base Cabinets

Tools Needed:

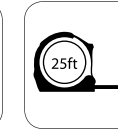
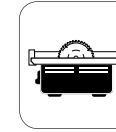
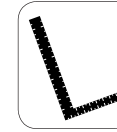

Test fit the filler making sure the toekick assembly is flush with the adjacent cabinets' toekicks and flush with the bottom.

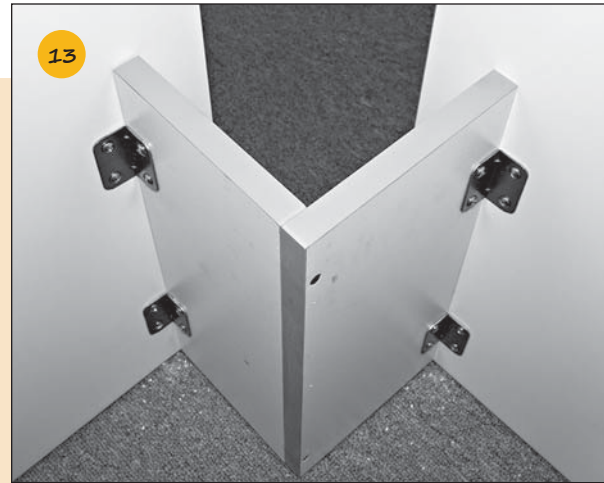

Attach the toekick assembly to the outside of each adjacent cabinet as this view from behind shows.

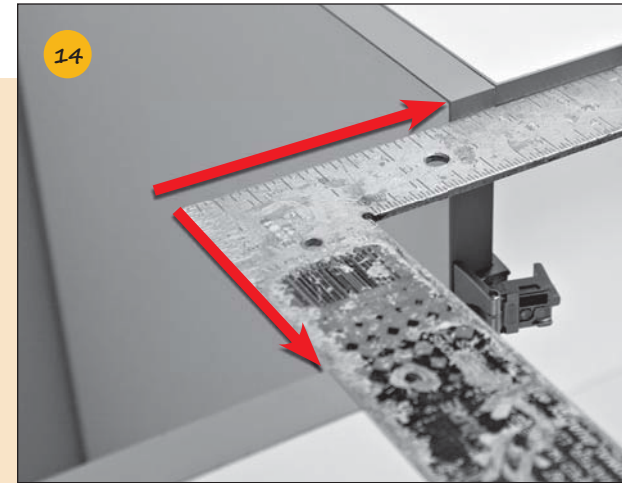

Next, measure and cut the filler assembly to the correct width.

TIP #4
Use a counter-sink drill bit for finishing the holes. This will prevent the screws from interfering with possible shelf locations.

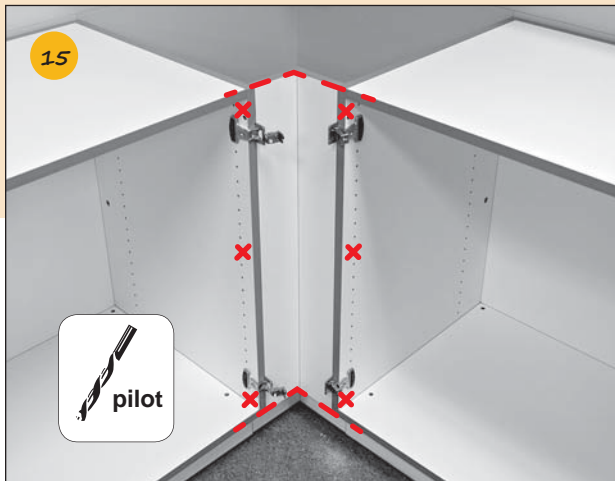

Test fit the filler assembly making sure that it is flush with the top and bottom of the adjacent base cabinets. Select three (3) spots to drill pilot holes for securing filler assembly. The top interior shot illustrates how the filler nests in front of the toekick assembly to create an overlap.

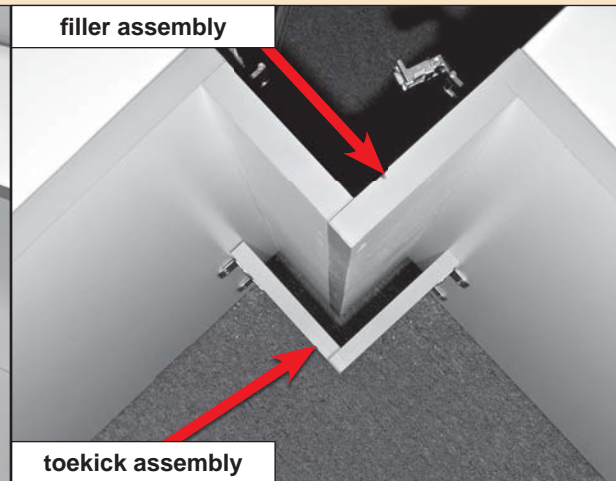

Filler should be flush with the front of cabinet body & bottom of cabinet. Secure in place with fastener screws in the previously marked areas.

Installing AMCASE® Base Cabinets

Tools Needed:

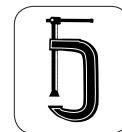
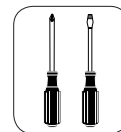
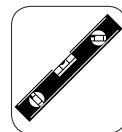

TIP #5

Use a backer such as a piece of wood when drilling through side panels to avoid chipping laminate surface.



17

Continue to place and level remaining cabinets according to plans until all cabinets are in position.



18

Clamp each cabinet's sides together on the top and bottom. Select a system hole near the top and bottom of each cabinet to use for joining.



19

TIP #5

Using a 1/4" drill bit, ream one system hole on the top and one on the bottom of the side panels for connecting bolts.



20

Use the provided connecting bolts in the hardware box to secure the top and bottom of the side panels together.



21

Once all base cabinets are fastened together with connecting bolts, we are almost ready to install work surfaces.



22

Attach doors to cabinets that will not have work surfaces mounted to them such as this locker cabinet. We are now ready to install work surfaces.

Notes

On Installing Base Cabinets

REVIEW

1st Cabinet

The first base cabinet to be placed should be on the highest point of the floor. All other cabinets will be raised up to be level with this cabinet.

4 mm

Wrench size for adjusting levelers on base cabinets.

1/4"

Drill bit size for reaming holes for connecting bolts.



Installing AMCASE® Work Surfaces

Welcome. This page is a guide to installing AMCASE® work surfaces efficiently and accurately. Please review the list before getting started.

Quick Steps Overview:

1. Review plans and setup
2. Install support panels/brackets
3. Scribe cut work surface to fit
4. Attach work surfaces to cabinets
5. Backsplashes / Sidesplashes / Caulk
6. Grommets

Tools Needed:

- Belt Sander
- Caulking Gun & Caulk
- C-clamps (variety)
- Circular Saw
- Cordless Drill
- Drill Bits - Metal/Wood
- Hand Screwdrivers
- Hole Saws (60 mm, 80 mm)
- Jig Saw
- Router
- Rubber Mallet
- Safety Glasses, Boots, Hat, etc.
- Shop Vac
- Table Saw (Lam. Cutting Blade)
- Tape Measure

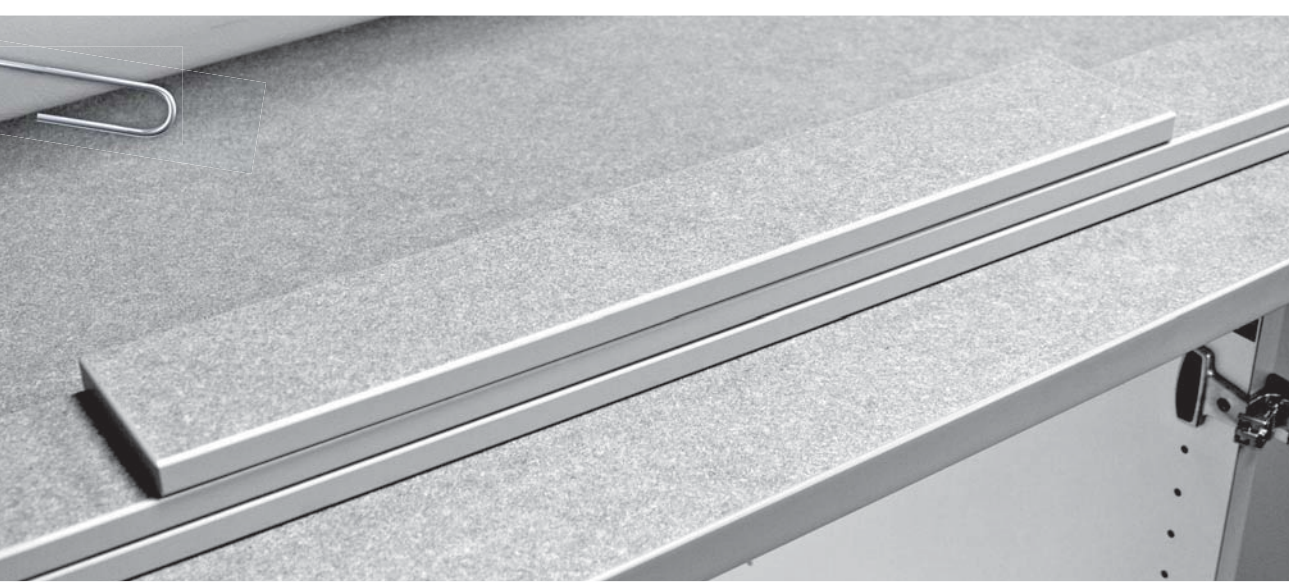

Work surfaces are the home stretch of an installation – the final step to completing an installation. Read all about the tips and tricks to make your installation go seamlessly.

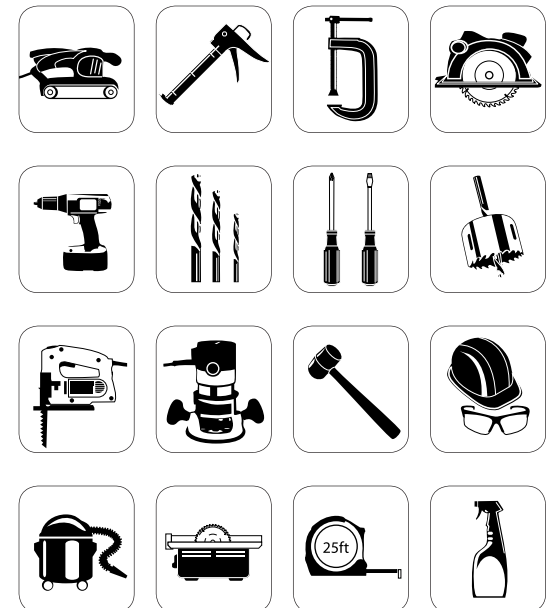

Installing AMCASE® Work Surfaces

Tools Needed:

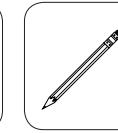
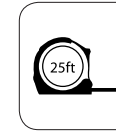
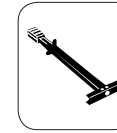
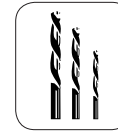

Review plans and assemble support panels for work surfaces. Thread levelers into the bottom panel inserts as required.



TIP #1

Attach angle brackets to the top of each support panel according to drawings.



Once support panel is positioned and the top is level with base cabinets, secure in place with screws using the system holes.



TIP #2

Some situations may require additional support in corner applications. Here, an angle bracket is used with togglers and bolts. Drill marked holes with a 1/2" drill bit. Be mindful of services (plumbing, electrical, etc.) in the wall before drilling.



TIP #3

Mark drill hole positions on the top of each cabinet where you intend to fasten the work surface down.

TIP #1
Place an angle bracket against the edge of the panel to keep brackets flush when fastening down.

TIP #2
See installing overhead cabinets for how to install wall togglers.

TIP #3
When drilling pilot holes, choose an area that you will have easy access to from underneath to attach the work surface.

Installing AMCASE® Work Surfaces

Tools Needed:

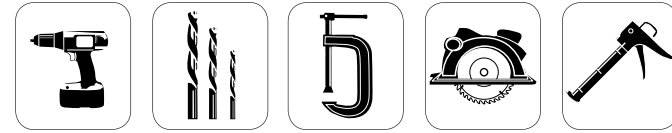

TIP #4

Support panels are recommended every 36" of unsupported work surface.

TIP #5

Uneven walls may require clamping push sticks in place to hold the backsplashes against the wall until the caulk sets.

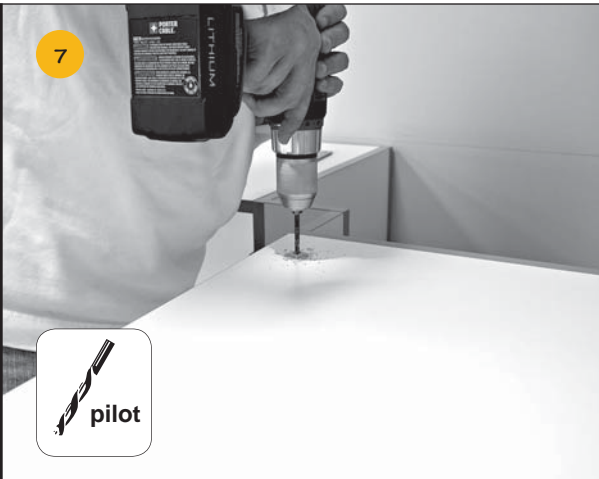

Drill pilot holes in the marked spots on the top of each base cabinet.



Place the work surfaces in place, and scribe cut to fit. Use a jig saw or belt sander as needed to fit the cut edge to an uneven wall.



After scribe cutting the work surfaces, place and fasten them down with screws from underneath using the pilot holes.



Attach an additional support panel to the work surface. Toggles should be used to fasten the wall bracket to the wall if a stud is not available.



Scribe cut backsplashes and sidesplashes to fit. Apply caulk to the back and clamp in place until dry.



Once complete, clean the area with a vacuum. Next, we will finish with leveling doors, drawers, and installing the pulls.

Notes

On Installing Work Surfaces

[illegible]

1/2"

60 mm

80 mm

Hole
saw size
needed
for larger
grommet
applica-
tions.



Installing AMCASE® Fit & Finish

Tools Needed:

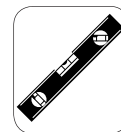
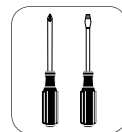

TIP #1

When adjusting the doors, focus on getting the doors to hang parallel to each other and making sure that the bottom of the doors are flush.



Once the work surfaces and backsplashes are installed, place shelves in all cabinets using the supplied hardware.



Use the metal shelf pins for storage and base cabinet shelving and the black clips for overhead cabinets.



Next, reattach the doors on all base cabinets and replace the drawers.



After all the shelves, doors and drawers have been installed, the next step is to level the doors.

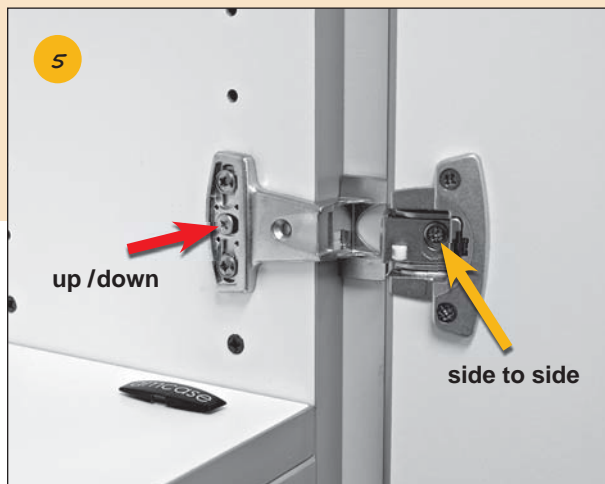

Remove the hinge cover cap and turn the adjustment screw. This adjusts the door up and down. The adjustment screw in the door mount adjusts the door side to side.

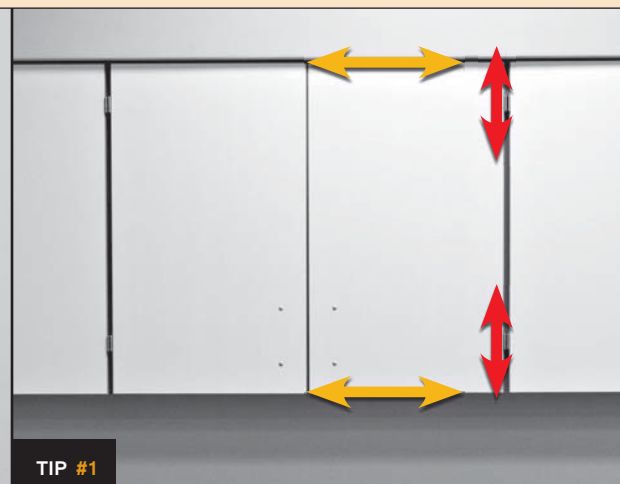

TIP #1

Installing AMCASE® Fit & Finish

Tools Needed:

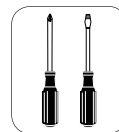

TIP #2

After the door is aligned properly, lock each hinge in place with one (1) set screw. Product warranty is void without proper use of set screws.

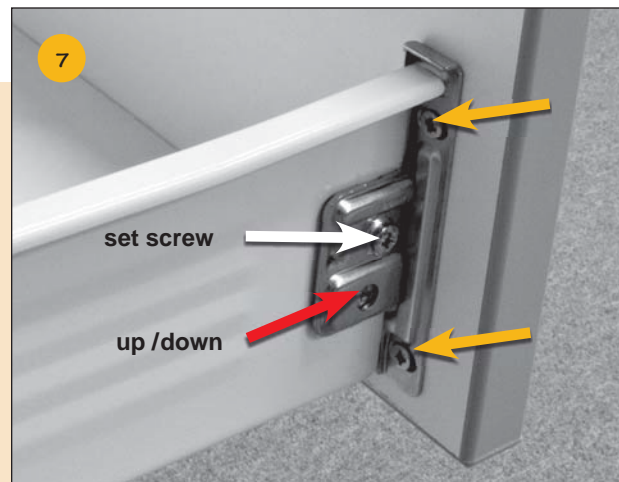

Adjust all drawer fronts until they are level and aligned with each other. Loosen the set screw first. Then, turn the appropriate adjustment screw on each side of the cabinet drawer side to adjust the fronts. Once aligned, tighten the set screw to lock in place.

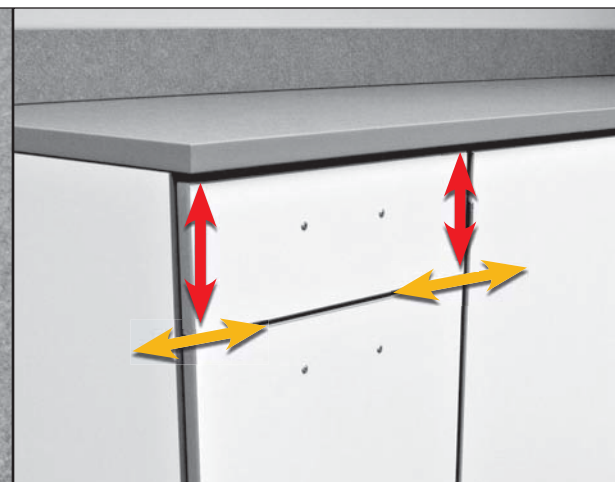

TIP #2

It is important to use set screws after the doors have been aligned. This adds additional support to the hinge and helps to keep the door properly aligned.



The pulls are installed on the inside of each cabinet to protect them during shipping. Take a moment to remove all pulls and install them facing outward.



TIP #3

Clean the area and wipe down the casework as needed. Congratulations! The installation is now complete.

TIP #3

When cleaning the installation, make sure to use the proper multi-surface cleaner to avoid damaging any surfaces.

Notes On Installing

On Installing

[illegible]

Notes

On Installing





Installation Manual

A reference guide for installing AMCASE® product.



2880 Ridgewood Park Drive, Winston-Salem, NC 27107

p: (888) 396-9060 f: (336) 499-5992

www.amcase.com